

Installation Guide

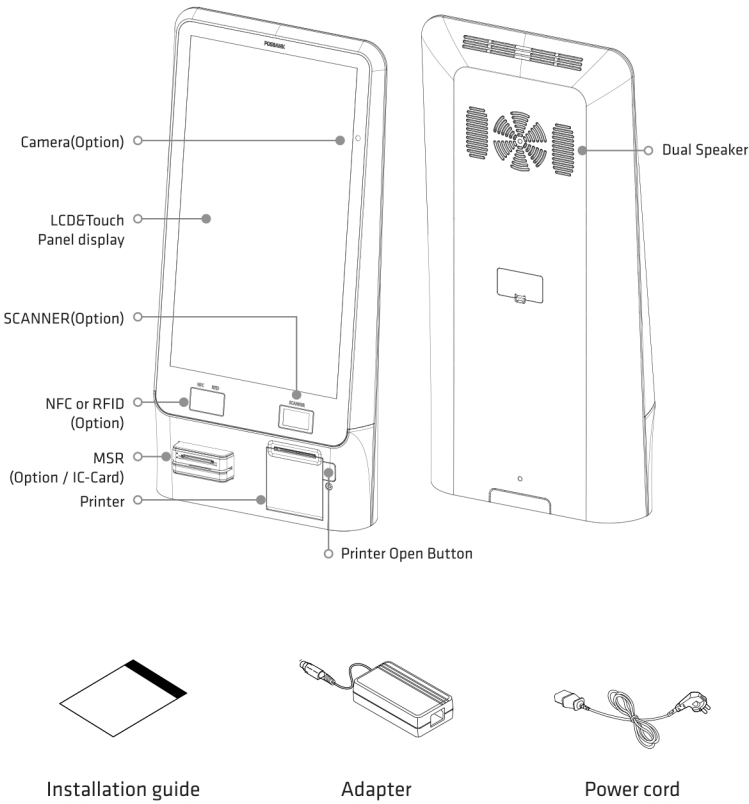

2. Power connection and external port

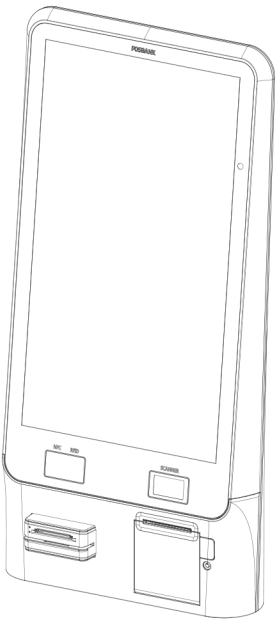
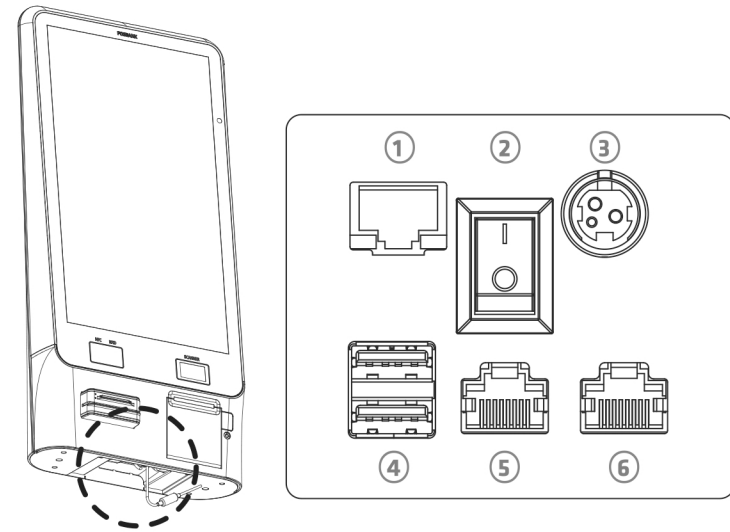

Description		Description	
1	LAN Port	4	USB 2port
2	Main ON/OFF Button	5	COM3 Port / RJ45
3	Power connector / DC 24V 6A	6	COM2 Port / RJ45

※ I/O ports may differ according to product model or options.

※ Caution

When using the power and external port, lie the product down safely.
When disconnecting the power cord, be sure to pull it out from the cap.

3. Power management

Be sure to use only the supplied adapter.

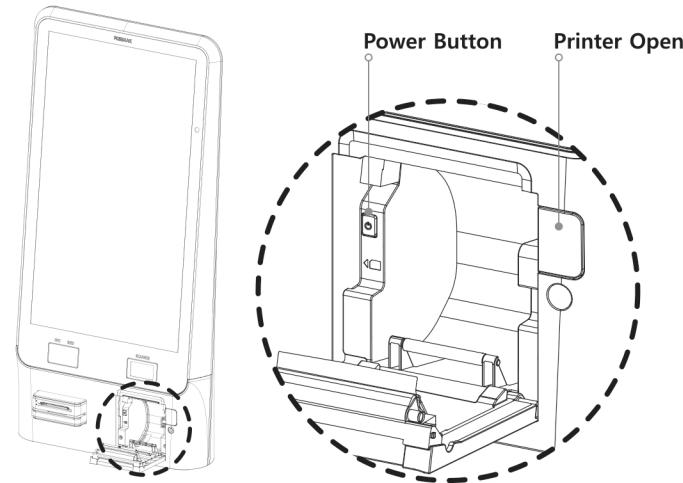

Step 1. Press 'OPEN' Button to open printer cover.

Step 2. It can be managed on/off with the power button inside the printer.

Window

※ To turn on the power, press and hold the power button.

※ To turn off the power,  →  → clicking [Shutdown]

4. Printer Paper Replacement

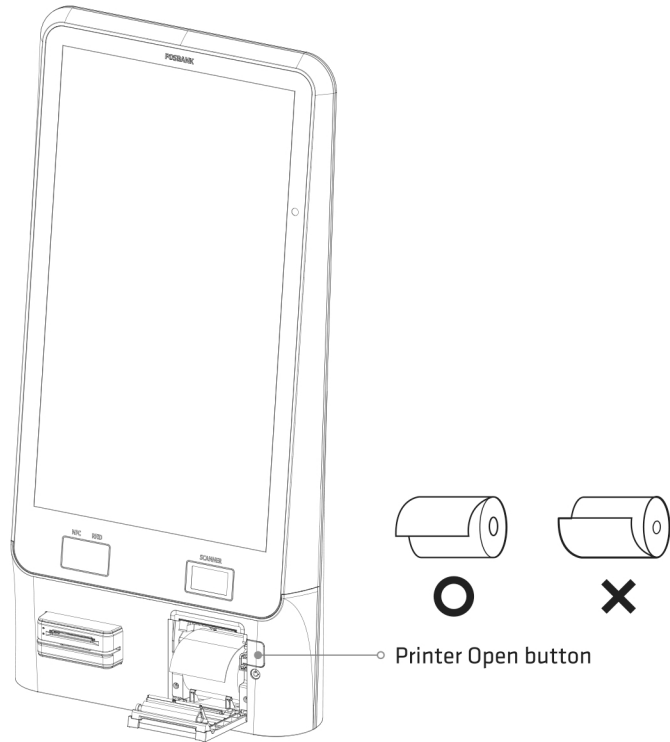

Step 1. Press 'OPEN' Button to open printer cover.

Step 2. Insert a new roll of paper in the correct orientation.

Step 3. Pull the roll of paper and set it in the middle of printer

and close the printer cover.

5. Stand assembly

Turn off the power prior to working on the POS system.

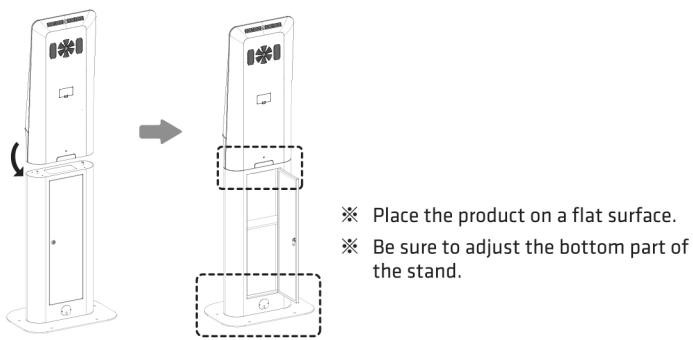

Internal view (screw assembly location)

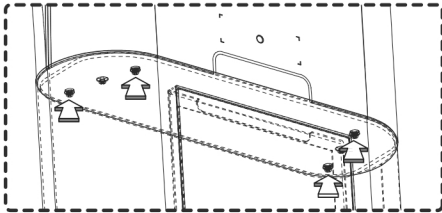

Step 1. Assemble the unit vertically on the stand.
(There are 2 fixed guides on the stand.)

Step 2. Open the stand door and assemble the 4 screws inside.

Stand Bottom view

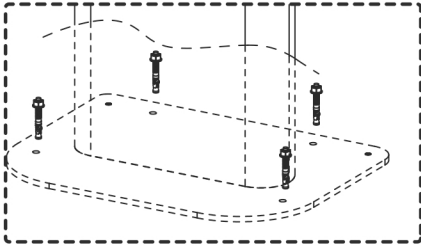

Caution
- Fix at least four bolts.

Information

• Copyright

This publication, including all photographs, illustrations and software, is protected under international copyright law with all rights reserved to the manufacturer. Neither this manual nor any of the material contained herein, may be reproduced without express written consent of the author.

This manual are furnished for informational use only.

The information contained in this document is subject to change without notice.

We make no warranty of any kind with regard to this material, including, but not limited to, the implied warranties of merchantability and fitness for a particular purpose. We shall not be liable for errors contained herein or for incidental or consequential damages in connection with the furnishing, performance, or use of this material.

• Warranty & Service

- For specific technical follow-up service and customer support, contact distributor in your country (seller or importer).
- We guarantee our POS terminal product and its parts against defects in materials and workmanship under proper use for a standard period of 2 years from the date of original purchase.
- For following cases, we will charge for repair and delivery.

- HDD partition division or re-installation of newly purchased OS which is requested by user.
- Customer's requests for connecting and setting-up Internet or Network (LAN).
- Re-installation of OS or software by customer's request.
- Request of instruction or service about other company's software (Contact the relevant company).
- Re-installation or reset of OS or software which is not caused by Hardware defect.
- Request for installation of optional parts (memory, SSD, etc.) purchased by customer additionally.
- Installation request or inquiry of new kind of device purchased by customer additionally (Contact the relevant company).
- Requesting engineer's visit or instruction without any specific problem.
- Request related to changing place caused by moving or transfer.
- Malfunction caused by user's carelessness, intention and mistake.
- Disorder caused by not suitable environment according to 'Warning' and 'Caution' instructions.
- Breakdown caused by user's mistake and careless treatment (falling, drowning, clash, crack).
- Breakdown caused by random repair or remodeling.
- Defect caused by connecting incorrect AC adapter.
- Malfunction caused after getting inappropriate repair by not assigned service center.
- Error caused by using optional devices (cable, adaptor, paper, etc.) not supplied by us.
- Abnormal functioning caused by using pirated Software and not using original Software.
- Reinstalling printer driver because of environment change (system change/reset) or virus infection.
- Using unstable AC power which cannot absorb impulsive current of electricity.
- Breakdown caused by natural disaster (fire, earthquake, flood, etc.)
- Reaching the life span of expendable devices (mechanism, auto cutter, battery, etc.).

Installation Guide

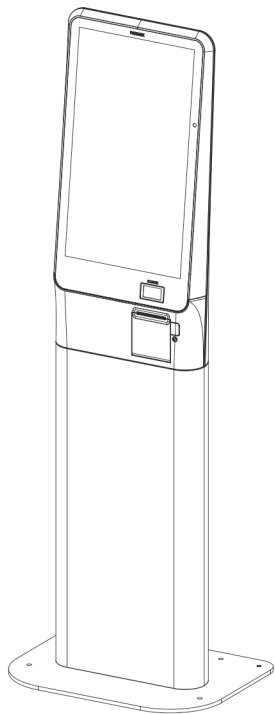

1. Package contents

The following items are included when you purchase this product. If any of these items are damaged or missing, contact your dealer for assistance.

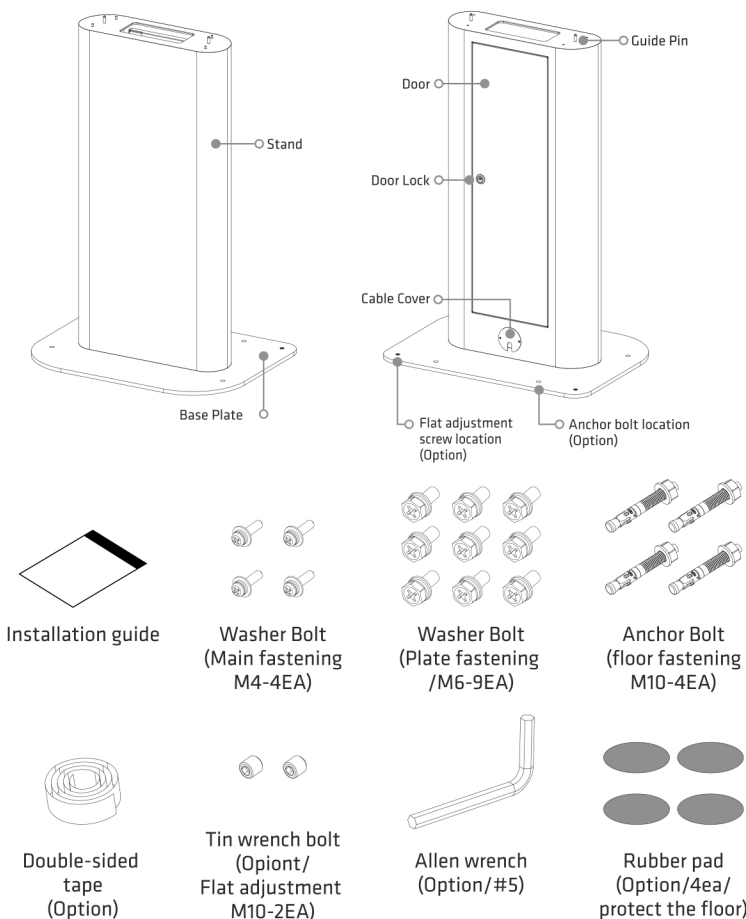

2. Assembling the stand and base plate

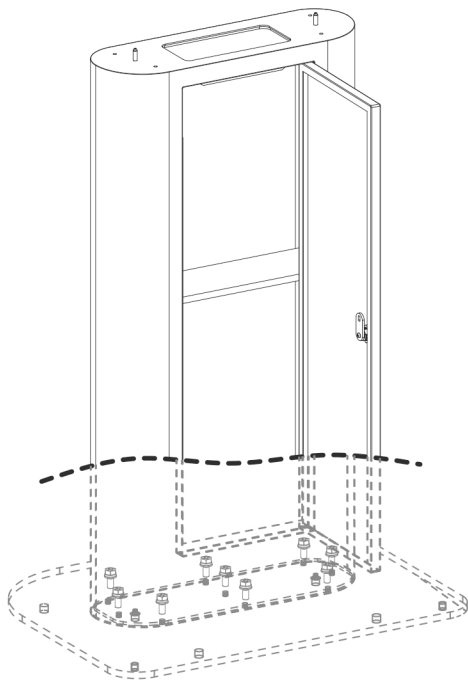

Step1. A guide is protruded from the stand. With the protruding guide, align the holes on the base plate.

Step2. Use included 9x Washer Bolt (M6) to secure both the stand and base plate.

Caution: Be sure to fix all nine screws.

3. Stand assembly

* Turn off power prior to work.

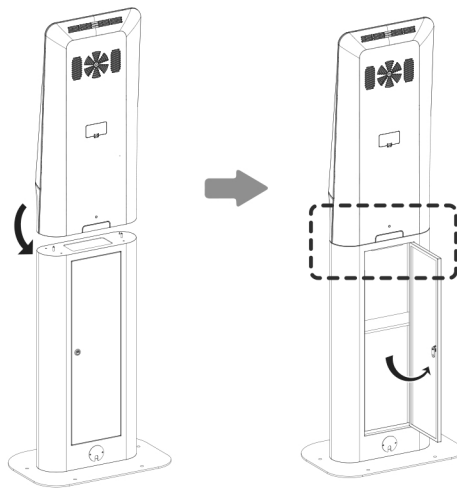

Internal view (screw assembly location)

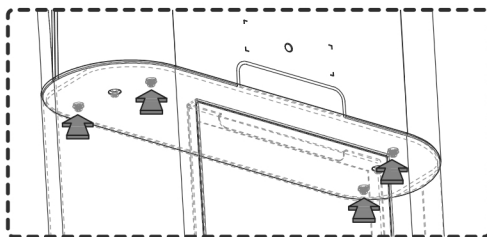

Step 1. Assemble the unit vertically on the stand.
(There are 2 fixed guides onto the stand.)

Step 2. Open the stand door and assemble the 4 screws inside..

4. Fixed anchor bolt (4x pieces required)

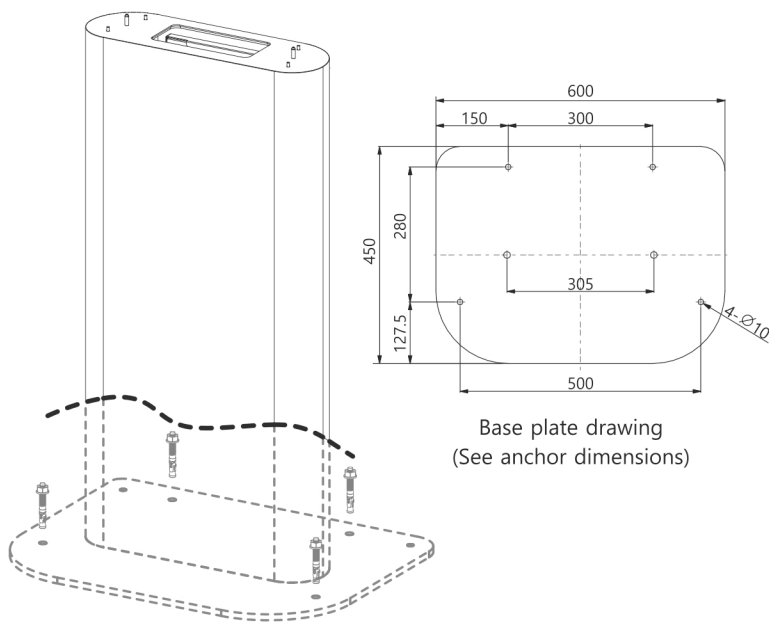

Step1. Refer to the drawing to make four Ø10mm holes.

Step2. Fix the four bolts to the Ø10mm hole.

Caution

- **Fix at least four bolts.**

- **If anchor bolts are not used, Posbank will not be liable for any property / bodily injury damages.**

- Installation choices -

1. Attaching double-sided tape to stand

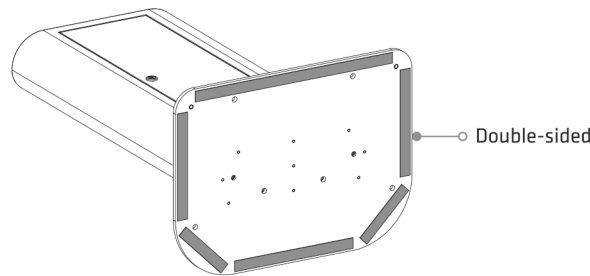

Step1. Lay the stand down and attach the double-sided tape referring to the image.

Step2. Place the product in the desired location.

Caution

- **Remove dirt, water and grease from adhesive surface prior to use.**

- **Press the adhesive tape firmly for 3 seconds after attachment.**

2. Level control (optional)

* Helpful when leveling the product.

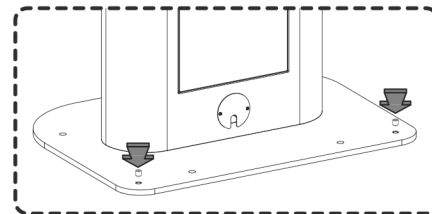

Step1. If the product is not leveled, use the included tin wrench bolt (M10).

Step2. Align the supplied hexagonal wrench roll.

3. Rubber pad attachment

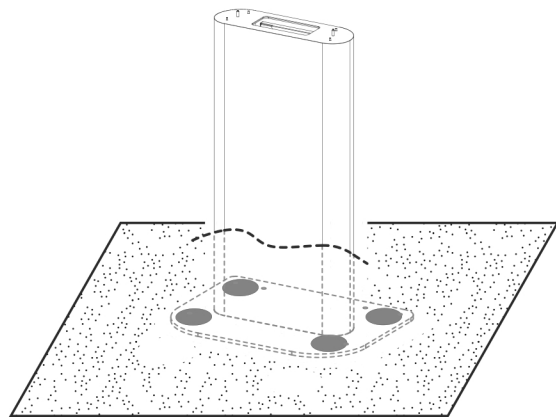

Step1. Attach the rubber pads to the flat surface (ground).

Step2. Place the stand on the rubber pad.

* **Rubber pads are used to protect the floor.**

* **Remove any debris on the adhesive side of the rubber pad.**

Caution

1. If an anchor bolt is not fixed, the product will not be liable for any property/bodily injury damages.
2. All work should be done on a flat surface.
3. Product should be placed on a flat/leveled surface.
4. Due to the weight of the product, it must be equipped with safety equipment.

* If the above contents are not followed, Posbank will not be responsible for any direct or indirect damages.

⚠ Cautions

● Warning

Instruction for low reliability or fire/electric shock/damage

1. Do not disassemble or remodeling the products except professional engineer.
 2. Do not pour water or liquid into the system.
 3. Ground the product before install the system.
 4. Do not touch power cord during extreme thunder storm.
 5. Do not touch power cord with wet hand.
 6. Do not pull power cord or other peripheral device cables.
 7. If abnormal smell, sound, or smoke is occurred, remove power cord immediately and call to your close service center.
 8. Do not use damaged power cord or plug (outlet).
 9. Keep away the product and vinyl package from children.
 - Children can be choked, if they pull the vinyl over their head.
 10. In case of boot failure after abnormal(forced) termination, please unplug the power cord and plug it in again.
 11. This device, its installed OS and software are vulnerable to security, so you should use a separate security program.
 - Do not use unnecessary shared folders / Set up PC firewalls / Do not install illegal software / Illegal OS, no software, no unverified site access
- ※ In case of hacking or equipment malfunction, the user shall not be held responsible.

● Caution

1. We recommend using proper power voltage (110V/220v) as a precaution against fire and electrical shock
2. Before install the product, check suitable and safe place to use.
 - Find well ventilated place. Avoid the place close to possibility of fire.
 - Avoid high moisture and humidity.
3. Do not install or keep the product on steep place.
 - It can cause damage or malfunction by falling (crash).
4. Be aware of electro-static on PCB of system with anti-static appliance;
 - This may cause low reliability and short life term.
5. Place a product away from highly static areas.
6. Do not put metal or obstacle in product.
7. Use product in simple power cord plug-in circumstance.
8. Only use adapter supplied.
 - If an incorrect adapter is used, the product's performance may decrease and there is an increased risk of explosion.
9. Use standard outer port.
 - Port can be damaged by connecting not standardized device.